

Preferred Specimen Collection Devices

Test	Collection device	Collection method	Special instructions
Rapid Strep			
Rapid Group A Strep	Foam tipped swab (swab in kit)	Throat	ID NOW
Throat Culture			
Throat Culture	ESwab (white or blue)	Throat	
COVID, RSV, and Influenza			
COVID-19	Foam tipped swab (swab in kit) + Hard Sided Transport Tube	Nasal	ID NOW
RSV	Foam tipped swab (swab in kit)	Nasopharyngeal	ID NOW
	Universal viral transport system (UVT)	Nasopharyngeal	ID NOW, For transport
Influenza (Flu) A+B	Foam tip swab (swab in kit)	Nasal	ID NOW
	Universal viral transport system (UVT)	Nasopharyngeal	For transport
Respiratory Panel PCR	Universal viral transport system (UVT)	Nasopharyngeal	
Respiratory Panel Mini			
Stool			
Gastrointestinal (GI) PCR	Culture and sensitivity stool transport vial	Liquid stool	Add enough stool to displace media to line on the vial
Parasitic Exam	Alcorfix Parasep SF Patient Care Kit	Liquid stool	
C. difficile PCR	Sterile Cup	Liquid stool	
Urine			
Urinalysis and Urine Culture	Sterile cup	Urine- varies	
Urine Culture with >24 hr transport	Urine culture stabilizer tube	Urine- varies	Use sterile transfer straw
Urogenital			
GC Chlamydia	Aptima unisex swab collection kit	Endocervical, Urethral	Blue swab only, discard white cleaning swab
	Sterile cup	Urine	First catch (do not void prior to collection)
	Aptima Multitest Swab	Rectal, Throat, and Vaginal	
Gardnerella, Trichomonas, and Yeast	BD Affirm VPIII collection kit	Vaginal	BD Affirm method
Wet Prep	Copan dual swab (red)	Vaginal	Read within 15 minutes
Fetal Fibronectin (FFN)	FFN specimen collection swab and tube	Vaginal	
Group B Strep	Copan dual swab (red)	Vaginal/ Rectal	
Culture	ESwab (white or blue)	Urogenital	
Herpes			
Herpes	Universal Transport Media (UTM) with Flocked Swab (non-COVID)	Varies	Can be collected with Copan dual swab, but must be placed into UTM before freezing
Shingles/ Varicella			
Shingles/ Varicella	Universal Transport Media (UTM) with Flocked Swab (non-COVID)	Varies	Can be collected with Copan dual swab, but must be placed into UTM before freezing
Cultures			
Wound/ Aerobic	ESwab (white or blue)	Varies	Wound culture includes MRSA
Anaerobic	ESwab (white or blue)	Varies	
Sputum/ Lower Respiratory	Sterile cup	Varies	
MRSA (Nasal)	Eswab (white or blue)	Nasal	
Fungal			
KOH	Sterile cup/ syringe	Varies	Not performed on Vaginal sources-do wet prep
	Copan dual swab (red)	Varies	
Culture	Sterile cup/ syringe	Varies	
	Eswab (white)	Varies	
Other			
Acid fast	Sterile cup/ syringe	Varies	
Bordetella pertussis	Universal Transport Media (UTM) with Flocked Swab (non-COVID)	Nasopharyngeal	
Cytology	Sterile cup/ syringe	Varies	
Gram stain	Any tissue/ fluid in sterile cup/ syringe	Varies	Not stool or viral media

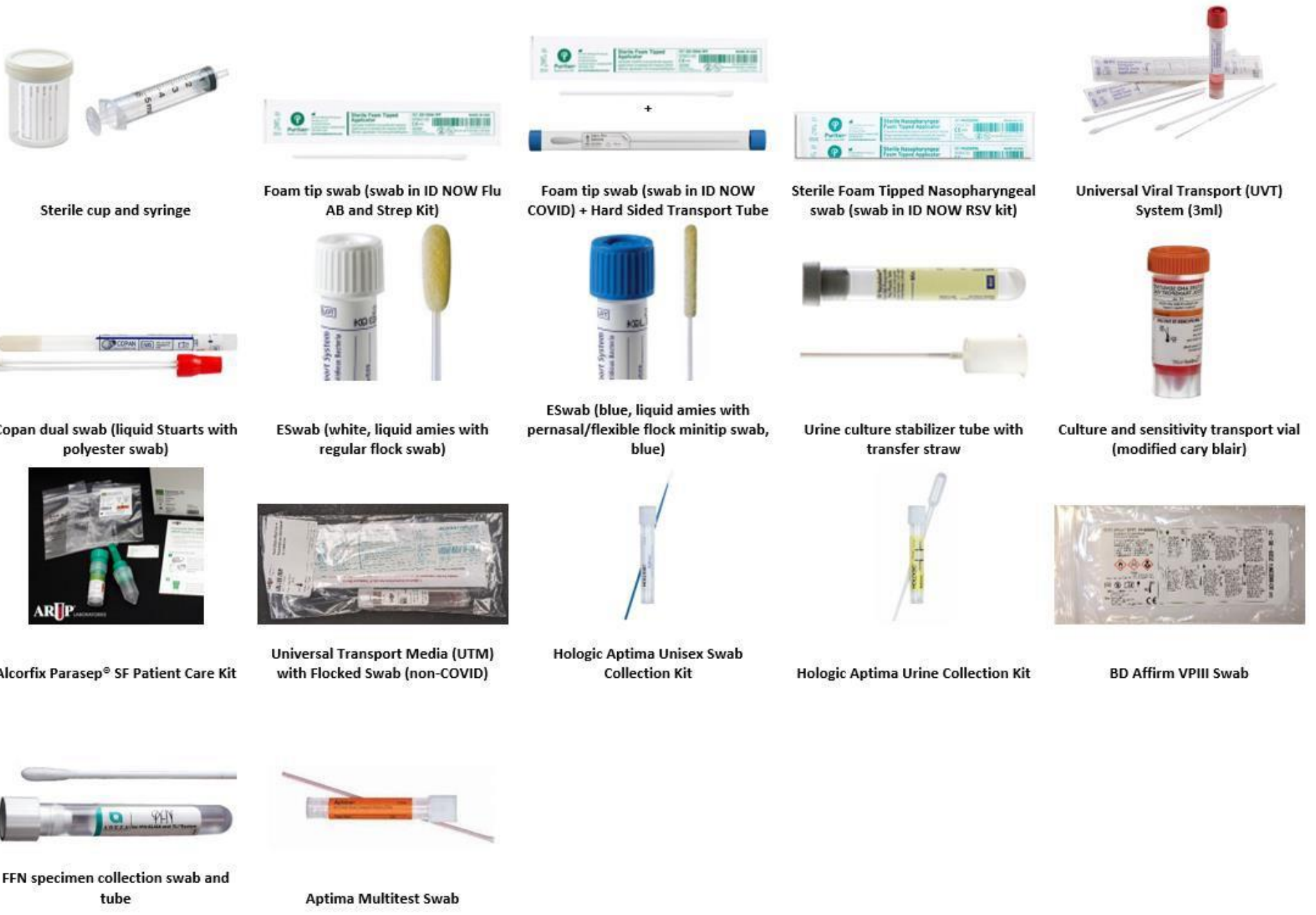

This chart only shows the preferred collection device for commonly ordered lab tests. If not on this chart, please call lab or reference the lab test catalog.

Last Updated: 12/06/2022