



Salem Health Stool Collection Guidelines

All specimens MUST be labeled with full name, date of birth, date and time of collection. Failure to record these items on each specimen may result in delay in testing or recollection of specimen.

If you were not given verbal instructions of appropriate temperature for your specimen or when to return your specimen to the lab, keep the specimen refrigerated/on ice (not frozen) and return it to the lab immediately. See below for lab location and non-holiday hours.

If you have questions after reviewing this document, please call our Client Services department at 503-814-5227.

Specimen drop-off location:

Salem Health Laboratory – State Street

3300 State St.

Salem, OR 97301

503-814-5227

Specimen drop-off hours:

Monday through Friday, 6:30 a.m. to 10:30 p.m.

Saturday, 7 a.m. to 4 p.m.

Sunday Closed

For test(s): Pinworm Examination

Use this container:

Pinworm Paddle Collection Vial

Instructions for Collection:

1. Obtain a special “Pinworm Paddle” collection vial from the laboratory. Stool specimens are not acceptable for pinworm examination.
2. A specimen is best obtained first thing in the morning before bath or bowel movement.
3. Remove the lid and paddle assembly from the vial provided. Do not disconnect the paddle from the lid. Touch the sticky side of the paddle to the perianal region.
4. Return the lid, paddle assembly to the container it came in, and tightly secure the lid on the container.
5. Keep the specimen at room temperature and deliver it to the laboratory as soon as the collection is completed.



For Test(s): Stool Culture, Cryptosporidium Antigen

Use this container: ETM Media

AKA: Cary-Blair, Stool Culture Preserve

Instructions for Collection:

1. Collect specimen in the provided collection hat. The stool must NOT be contaminated with urine or water.
2. Slimy, bloody, or watery stool, if present, should be selected and placed into the vial. Place enough specimen to reach the FILL LINE.
3. Carefully break up the specimen and swirl the contents until thoroughly mixed using the spork (attached to the cap). Screw on and tighten the cap without further mixing or shaking.
4. Label each vial with appropriate patient information and deliver the specimen to the laboratory without refrigeration or incubation.



For Test(s): Fecal Immunochemical Test (FIT)

Use this container: FIT Tube

Instructions for Collection:

1. Collect stool into provided collection hat
2. Unscrew the purple cap from the sample collection tube. **DO NOT POUR OUT THE LIQUID.**

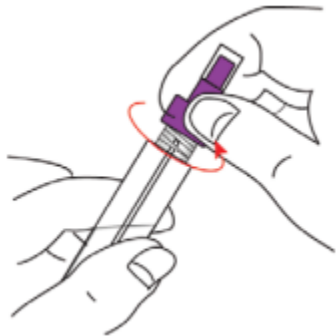

3. Poke spiral applicator into stool at 6 different sites. Use only enough fecal material to cover the tip of the applicator. **DO NOT CLUMP, SCOOP, OR FILL THE TUBE.**

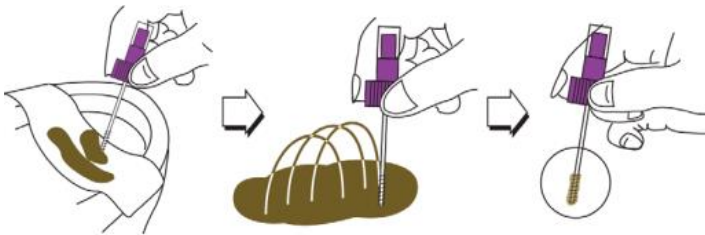

4. Screw the applicator back into the tube and secure tightly. Insert sample collection tube into specimen pouch and seal. Return the sample packet immediately to the laboratory.

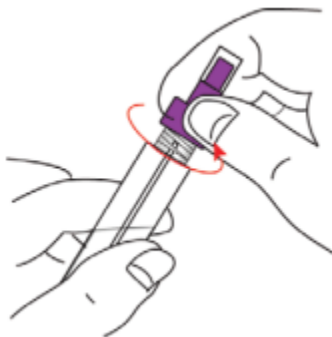

For Test(s): Ova & Parasite, Fecal

Use this container: AlcorFix

AKA: Parasep, ARUP Supply #52059

[CLICK HERE FOR VIDEO COLLECTION GUIDE](#)

Instructions for Collection:

1. Collect stool in provided collection hat. Do not use stool samples which have been contaminated with water, urine, or toilet paper.
2. Unscrew the lid of the tube containing the liquid and place it on flat surface where it will not be easily knocked over. Discard the cap.
3. Pick up a green/clear scoop assembly, holding the smaller tube by the conical end. b) Use the green scoop to collect: Liquid Stool: two level scoops Solid Stool: one heaped scoop of stool (see example in figure below).

Sample from the center of the stool

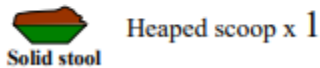
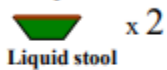

4. Place the scoop assembly containing the stool sample into the tube containing the liquid (do not separate the spoon from the tube attached). Screw together as tightly as possible—until you feel a “click”—that completes the seal. Leave fully assembled as shown in this diagram



5. Return specimen to laboratory at room temperature



For Test(s): Fecal Lactoferrin, Fecal Calprotectin, Fecal Pancreatic Elastase (and many others)

Use this container: Sterile Cup

AKA: Fresh Stool Cup, Plain Stool Cup

Instructions for Collection:

1. Collect stool into provided collection hat
2. Using provided tongue depressor, place stool from collection hat into the sterile cup. Fill the cup halfway, or as able.
3. Firmly seal the lid of the cup.
4. Keep refrigerated/on ice and return specimen to the laboratory immediately.

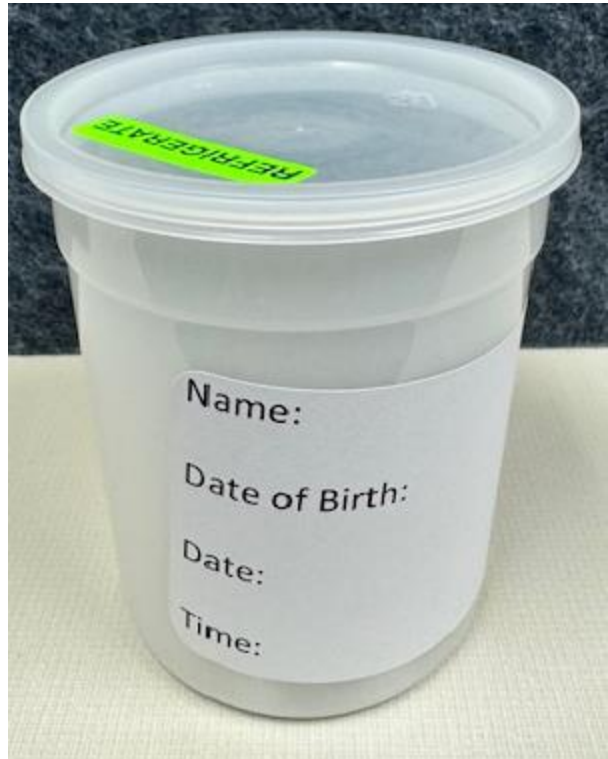

For Test(s): Fecal Fat 24, 48, or 72 hour collection

Use this container(s): ARUP Stool Collection Container

Eat a normal diet consisting of 50–150 grams of fat for at least three days prior to beginning fecal collection.

1. Lift the toilet seat and place the toilet adapter across the rim of the toilet bowl. Place the adapter so the shorter support bar lies across the middle of the toilet bowl and the longer support bar lies across the rear of the toilet bowl. (See Figures 1 and 2.)

2. Unscrew the cap from the collection container. Place the container in the hole of the toilet adapter.

3. Put the toilet seat down. The bottom of the container should rest in the water or just above it. Depending on the water level in the toilet and the shape of the toilet seat, the collection container may float and rise. As you sit, align the container to be sure your stool goes into the container. Do not collect any urine in the container.

4. After your bowel movement, remove the container from the toilet. Screw the cap onto the container and wipe the outside of the container dry. Refrigerate specimen until end of timed collection unless instructed otherwise by lab or provider.

5. When your collection is complete, make sure you have screwed the cap evenly and tightly onto the collection container.

6. Place the capped container inside the plastic bag. Seal the bag.

7. Continue to add stool to the container until it reaches the fill line, or the collection time is completed. You may need to use multiple containers.

8. Return specimen to the lab ASAP after full timed collection. Keep specimen refrigerated/on ice unless otherwise instructed by lab or provider.



Figure 1. This top view of a toilet shows how the collection container slides into the ring of the toilet adapter. The shorter support of the adapter lies across the middle of the toilet bowl rim. The longer support lies across the rear of the toilet bowl rim. The toilet seat is up.



Figure 2. This top view of a toilet shows the toilet adapter holding the collection container in place. The toilet seat is down.